

# C.I.P.

## 338 Lapua Mag.

Country of Origin: FI

TAB. I

Date 89-09-09

Revision 06-09-14

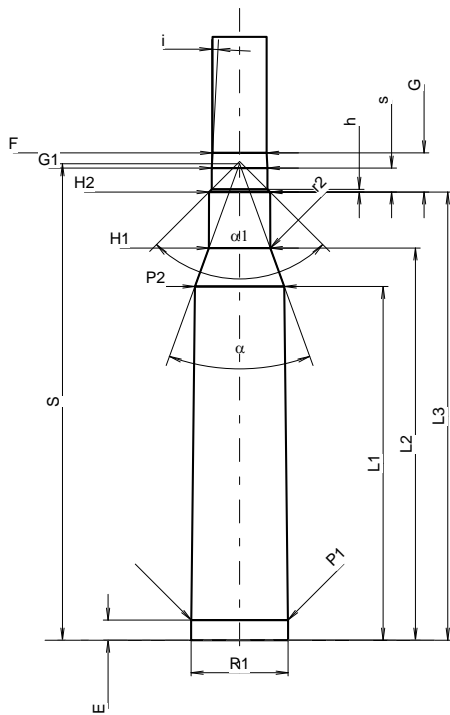
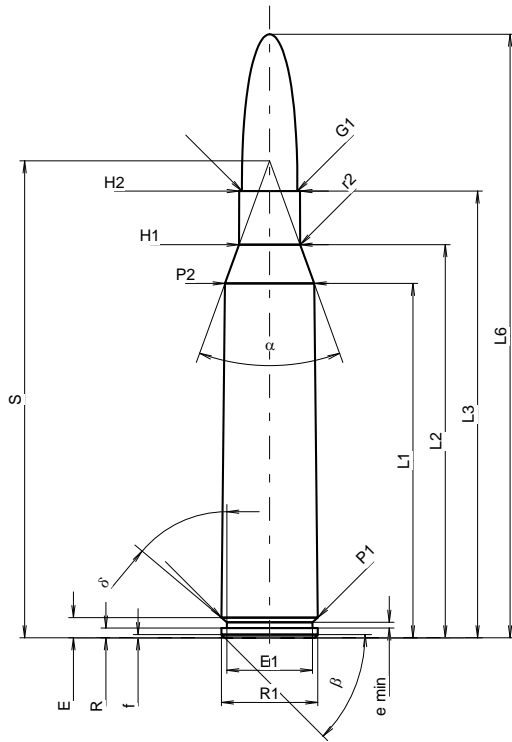

Scale 1:1.17

Dimensions in << mm >>  
Dimensions and Tolerances for Proof Barrels  
see Appendix CR 1.

### CARTRIDGE MAXI

#### Lengths

L1 <sup>1)*</sup>	=	54.90	-0.20
L2 <sup>1)*</sup>	=	60.89	-0.20
L3 <sup>1)</sup>	=	69.20	
L4	=		
L5	=		
L6	=	93.50	

#### Case Head

R	=	1.52	
R1	=	14.93	
R3	=		
E	=	3.12	
E1	=	13.24	
e min	=	0.90	
delta	=	50°04'48"	
f	=	0.50	
beta	=	45°	

#### Powder Chamber

P1	=	14.91	
P2 <sup>1)*</sup>	=	13.82	-0.20

#### Junction Cone

alpha	=	39°59'48"	
S	=	73.89	
r1 min	=		
r2	=	2.50	

#### Collar

H1 *	=	9.46	
H2 <sup>1)</sup>	=	9.41	

#### Projectile

G1 <sup>1)</sup>	=	8.61	
G2	=		
F	=		
L3+G <sup>1)</sup>	=	75.28	

#### Pressures (Energies)

##### Method Transducer

Pmax	=	4200 bar	
PK	=	4830 bar	
PE	=	5250 bar	
M	=	25.00	
EE	=	6600 Joule	

#### Miscellaneous Dimensions

Fe <sup>1)</sup>	=	0.10	
delta L	=	0.05	

Notes: 1) Check for safety reasons  
\* Basic dimensions

### CHAMBER MINI

#### Lengths

L1 *	=	54.81	
L2 *	=	60.77	
L3 <sup>1)</sup>	=	69.45	

#### Breech

R	=		
R1	=	15.03	
R2	=		
R3	=		
r	=		

#### Powder Chamber

E	=	3.12	
P1 <sup>1)</sup>	=	14.96	
P2 *	=	13.85	

#### Junction Cone

alpha <sup>1)</sup>	=	40°00'45"	
S	=	73.83	
r1 max	=		
r2	=	3.00	

#### Collar

H1 *	=	9.51	
H2 <sup>1)</sup>	=	9.45	

#### Commencement of Rifling

G1 <sup>1)*</sup>	=	8.63	
G <sup>1)*</sup>	=	6.08	
alpha1	=	90°	
h	=	0.41	
s *	=	3.70	
i <sup>1)</sup>	=	3°00'23"	
w	=		

#### Barrel

F <sup>1)*</sup>	=	8.38	
Z <sup>1)</sup>	=	8.58	

#### Grooves

b	=	2.79	
N	=	6	
u	=	254.00	
Q	=	56.86	mm <sup>2</sup>