

# C.I.P.

## 300 Whisper

Country of Origin: US

TAB. I

Date 09-05-05

Revision

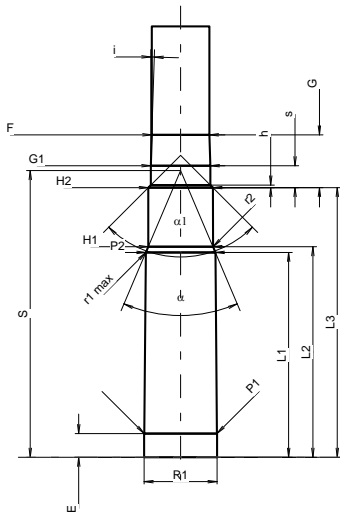
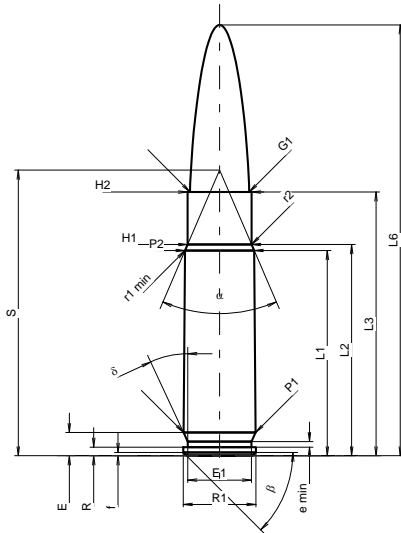

Scale 1:1

Dimensions in << mm >>  
Dimensions and Tolerances for Proof Barrels  
see Appendix CR 1.

### CARTRIDGE MAXI

#### Lengths

L1 <sup>1)</sup>	=	27.15	-0.20
L2 <sup>1)</sup>	=	27.94	-0.20
L3 <sup>1)</sup>	=	34.90	
L4	=		
L5	=		
L6	=	57.00	

#### Case Head

R	=	1.14	
R1	=	9.60	
R3	=		
E	=	3.07	
E1	=	8.43	
e min	=	0.74	
delta	=	25°	
f	=	0.45	
beta	=	45°	

#### Powder Chamber

P1	=	9.54	
P2 <sup>1)</sup> *	=	9.14	-0.20

#### Junction Cone

alpha *	=	46°30'	
S *	=	37.78	
r1 min	=	0.80	
r2	=	0.80	

#### Collar

H1 *	=	8.46	
H2 <sup>1)</sup>	=	8.46	

#### Projectile

G1 <sup>1)</sup>	=	7.84	
G2	=		
F	=		
L3+G <sup>1)</sup>	=	41.88	

#### Pressures (Energies)

#### Method Transducer

Pmax	=	3500 bar	
PK	=	4025 bar	
PE	=	4375 bar	
M	=	17.50	
EE	=	1100 Joule	

#### Miscellaneous Dimensions

Fe <sup>1)3)</sup>	=	0.15	
delta L	=		

### CHAMBER MINI

#### Lengths

L1	=	27.10	
L2	=	27.85	
L3 <sup>1)</sup>	=	35.67	

#### Breech

R	=		
R1	=	9.66	
R2	=		
R3	=		
r	=		

#### Powder Chamber

E	=	3.13	
P1 <sup>1)</sup>	=	9.61	
P2 *	=	9.20	

#### Junction Cone

alpha <sup>1)</sup> *	=	46°	
S *	=	37.93	
r1 max	=	0.50	
r2	=	0.50	

#### Collar

H1 *	=	8.56	
H2 <sup>1)</sup>	=	8.54	

#### Commencement of Rifling

G1 <sup>1)</sup> *	=	7.87	
G <sup>1)</sup>	=	6.98	
alpha 1	=	90°	
h	=	0.34	
s *	=	2.89	
i <sup>1)</sup> *	=	1°45'	
w	=		

#### Barrel

F <sup>1)</sup> *	=	7.62	
Z <sup>1)</sup>	=	7.82	

#### Grooves

b	=	2.20	
N	=	8	
u	=	203.00	
Q	=	47.39	mm <sup>2</sup>

Notes: 1) Check for safety reasons  
3) Headspace on Shoulder  
\* Basic dimensions